

QNAP

# TVS-675

QTS and QuTS hero dual O.S.: ZhaoXin KaiXian 8-core 2.5GHz  
NAS with 2.5GbE、GPU、HDMI、M.2 NVMe/SATA SSD slots  
and dual PCIe slots for network/storage expansion



x86



QTS / QuTS <sup>hero</sup>



# TVS-675 the 8-core SMB NAS with 4K graphics

**QTS / QuTS<sup>hero</sup>**

## Dual Operation Systems

Pre-installed QTS, optional enterprise ZFS QuTS hero



## Zhaoxin Kaixian U6580 8C / 8T 2.5GHz SoC

8-core/8-thread x86 processor, built in graphic processor

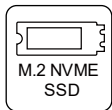

## 2 x M.2 PCIe NVMe/SATA SSD slots

Dual M.2 2280 NVMe/SATA SSD to boost performance



## 2 x 2.5GbE RJ45 (1Gb/100Mb ethernet support)

Dual 2.5GbE LAN ports w/ link aggregation

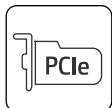

## 2 x PCIe 3.0 x4 Slots

Dual PCIe 3.0 x4 slots for network, storage, or M.2 SSD expansion



TVS-675

# QTS / QuTS hero dual operating systems for powerful and secure NAS applications services

The QTS operating system is preloaded by default. Businesses can switch to ZFS-based QuTS hero operating system with greater reliability based on the needs of different applications at any time.

## Attention :

1. Since QTS and QuTS hero use different file systems, users must not insert the old hard disks between different operating systems to avoid data loss.
2. When using QuTS hero, we recommend to use SSD as your system drives to gain better performance.
  - a. Hot swap drives by installing 2.5" SATA SSD in two 3.5" drive bays
  - b. M.2 NVMe SSD slots on motherboard do not support hot-swapping

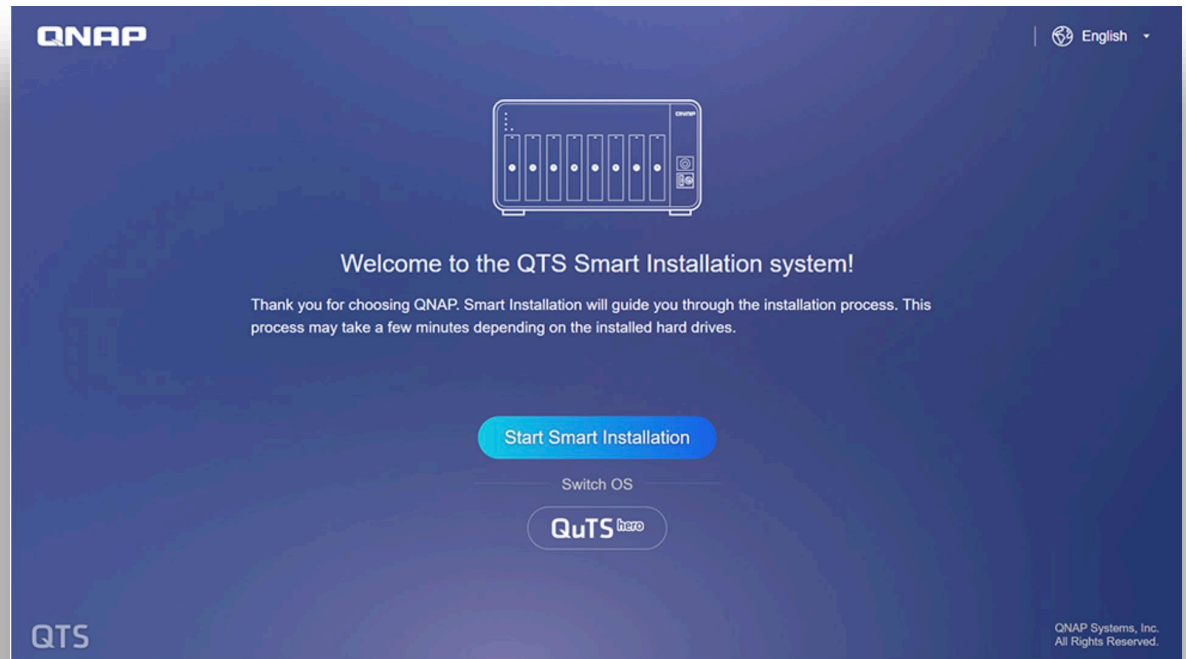

# TVS-675 NAS with 8-core 2.5GHz CPU, 8MB L2 cache, GPU with 4K transcoding and video output via HDMI 2.0

	TVS-675
CPU model	KX-U6580
# of core	<b>8</b>
# of thread	<b>8</b>
Base frequency	<b>2.5 GHz</b>
Burst frequency	---
L2 cache	<b>8MB</b>
VT-x / IO virtualization	Supported
Memory	DDR4
GPU	C960 chipset: <b>HDMI 2.0@4k</b>
CPU architecture	<b>X86</b>



TVS-675

Made in Taiwan

# Advanced 8-core 2.5GHz SoC with integrated 4K video graphics and multiple I/O lanes

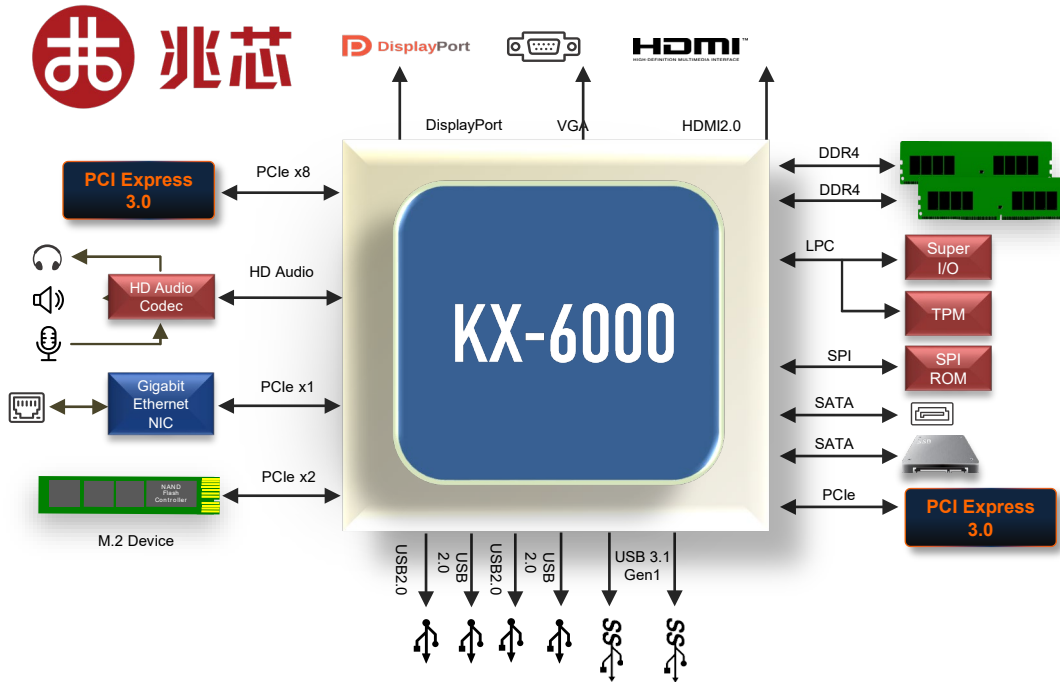

- The Zhaoxin 8C/8T KX-U6580 has lower latency while running multi-task application.
- Multi-core graphic processing unit to provide 4K video transcoding and HDMI output with HDMI 2.0.
- 8-core CPU suited for multiple virtual machines (VM) with the VT-x and IO virtualization support

“made using (Taiwan) TSMC’s 16 nm technology” - AnandTech

Reference: <https://www.anandtech.com/show/13388/zhaoxin-shows-x86-compatible-kaixian-kx6000>

# Background and core technology of Zhaoxin CPU



**Zhaoxin Inc.**

Founded in 2013, based on technologies from VIA



**3 key technology**

Zhaoxin has core CPU and chipset (South-bridge) technology, also integrated graphics chipset.

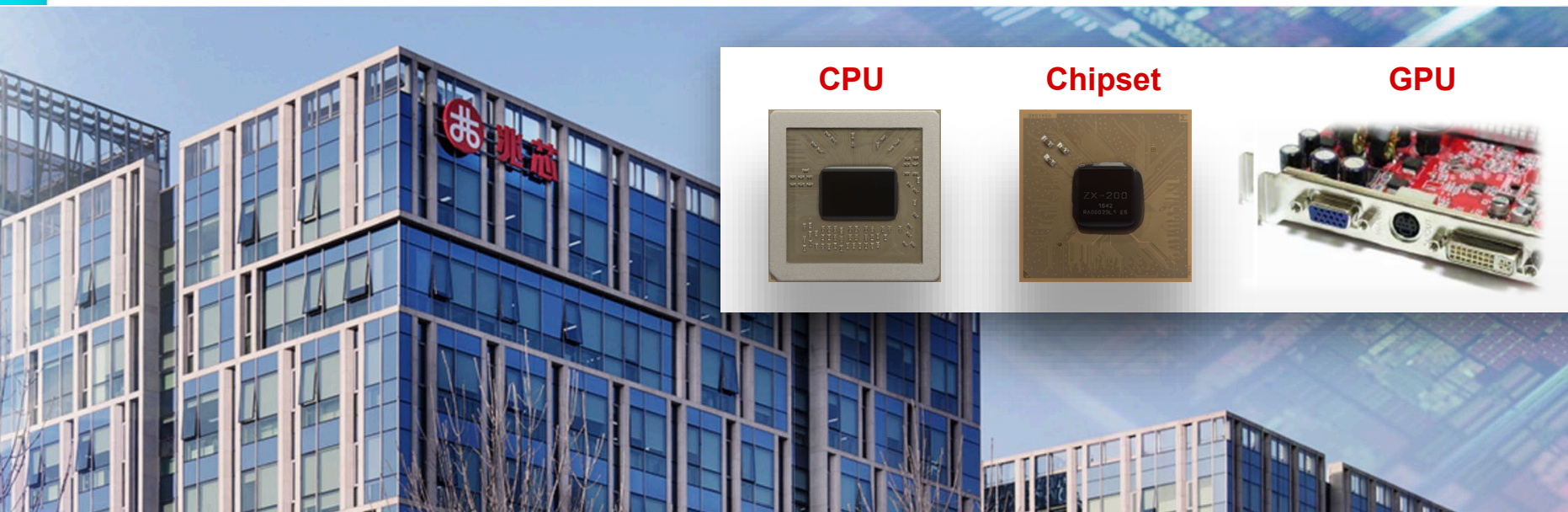

**CPU**



**Chipset**



**GPU**



# Trusted by the PC industry leaders. Many business-oriented desktops and laptops based on Zhaoxin solutions.

**ASUS D349SD desktop**  
Zhaoxin KX-5000 series CPU



Datasheet

**HP 268 Pro G1 MT**

Maximize your investment with a powerful CPU from China



**Lenovo CF4620 laptop**  
Zhaoxin KX-6000 series CPU



**Lenovo M630 desktop**  
Zhaoxin KX-6000 series CPU



**Lenovo S620 desktop**  
Zhaoxin KX-5000 series CPU



# TVS-675 Front view

**Lockable drive Trays**  
(2 keys are included)



LED:  
Status · Network  
HDD · M.2 SSD

6 x 3.5"/2.5"  
SATA 6Gb/s  
HDD/SSD slots



TVS-675

Power button

USB 3.2 Gen 2  
Type-A 10Gbps  
port and copy  
button



# Easy installation of disks and lockable trays

## 3.5-inch HDD

Tool-less  
installation of  
3.5-inch  
HDDs

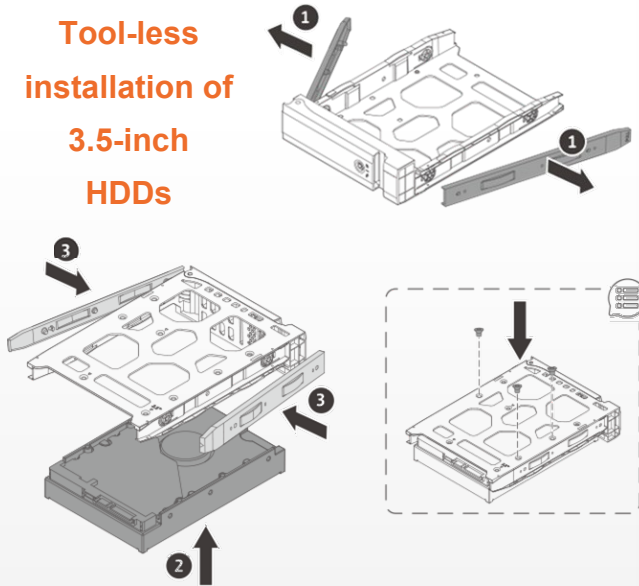

## 2.5-inch SSD / HDD

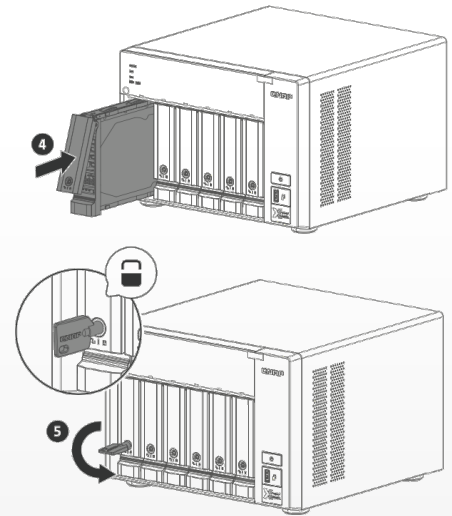
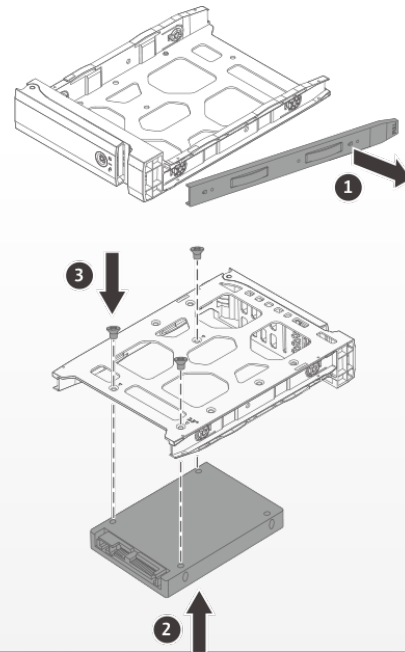

# TVS-675 Rear view

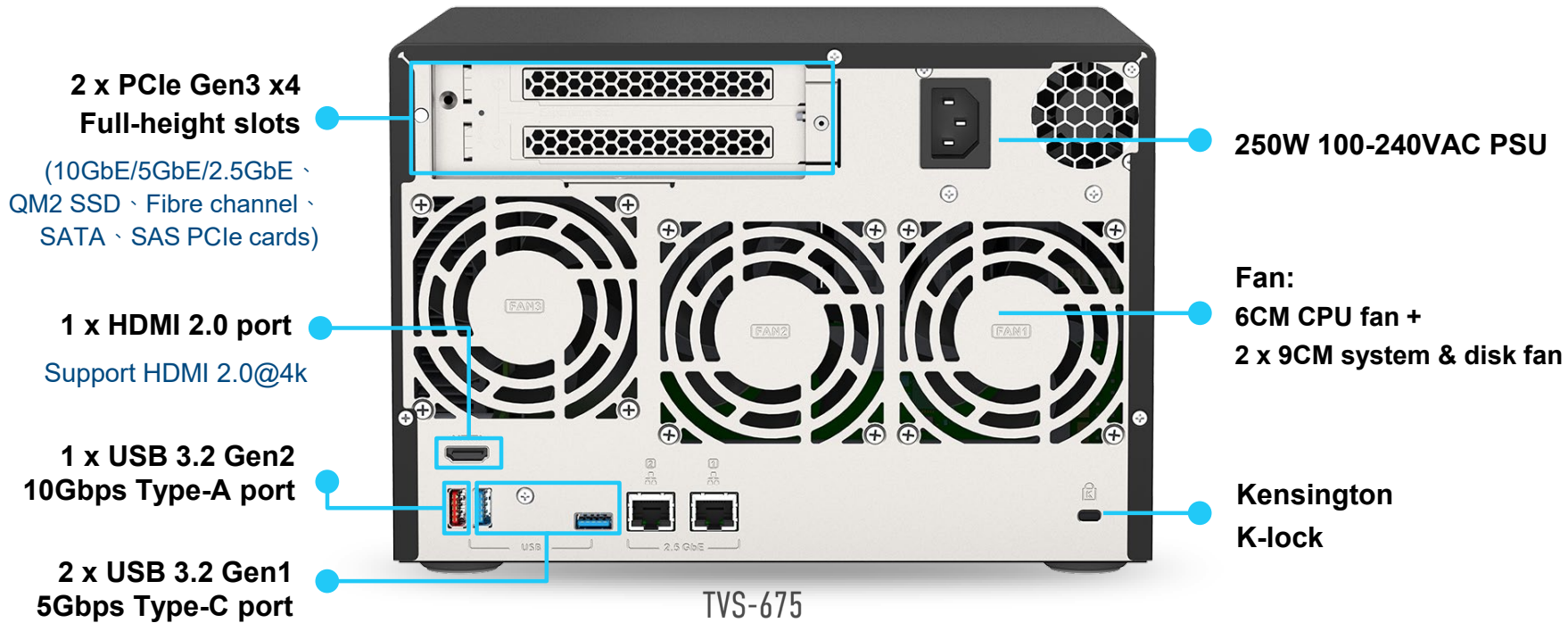

# TVS-675 Side view for RAM and M.2 SSD upgrades

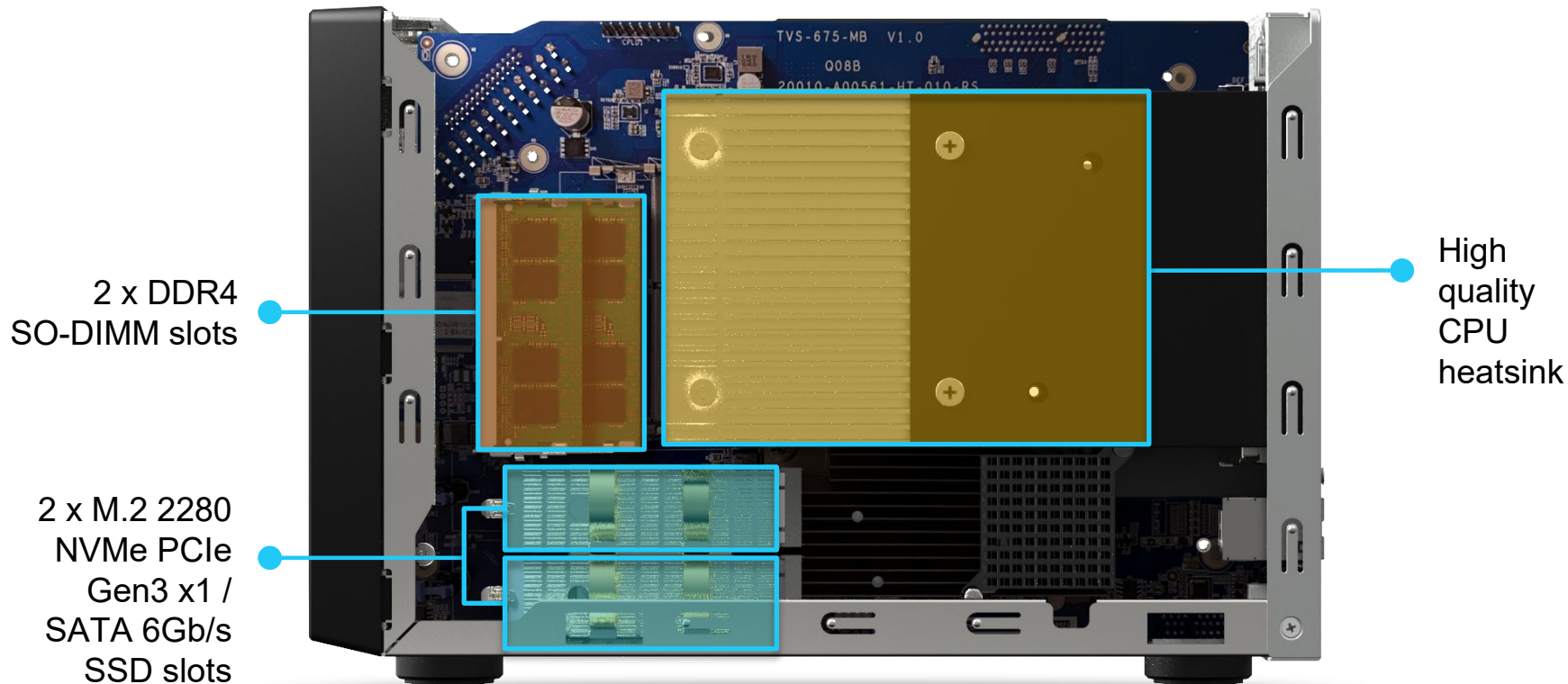

# 2 x M.2 NVMe PCIe / SATA SSD slots supporting SSD cache or Qtier auto tiering

## 2 M.2 2280 NVMe PCIe Gen3 /SATA NVMe SSD for SSD cache or Qtier auto tiering performance enhancement.

- **Improve random data access speeds with an SSD cache**  
SSD caches accelerate IOPS performance and reduce latency for storage volumes. They are perfect for IOPS-demanding applications (including databases and virtualization) and can significantly improve overall workflows.
- **Maximize the value of SSDs with Qtier Technology**  
Qtier™ Technology empowers the NAS with auto tiering that helps continuously optimize storage efficiency by automatically moving data between M.2 SSDs, 2.5-inch SSDs, and high-capacity HDDs based on the data's access frequency. Qtier™ 2.0 features IO-awareness that empowers SSD-tiered storage with a cache-like reserved space to handle burst I/O in real time, greatly maximizing the advantages of SSDs.

Note: Qtier is only supported in the QTS OS, not in the QuTS hero OS.

### 1. Remove screws and cover

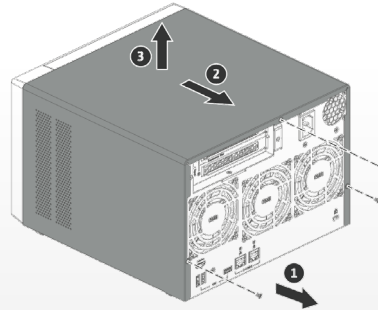

### 2. Install M.2 SSD

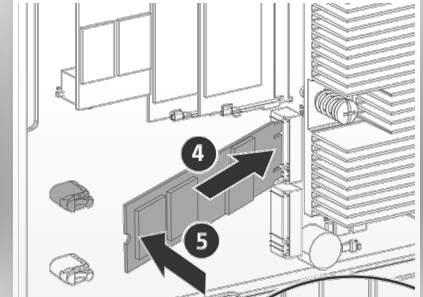

### 3. Tool-less M.2 SSD installation

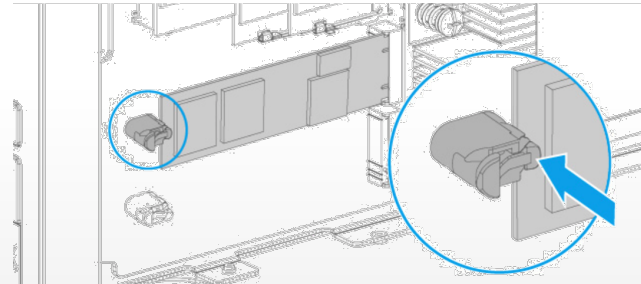

# M.2 NVMe/SATA SSD and Qtier auto-tiering for speed and capacity

## Qtier engine



- Automatically moves data between different tiers
- SSD tier capacity is not limited by RAM size

01

**Before tiering**  
Frequently accessed data is not optimized.

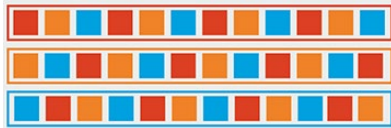

02

**Start tiering**



03

**After tiering**  
Data is optimized

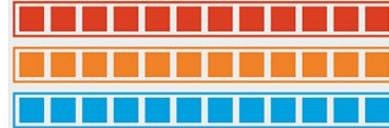

04

**Changes in data access pattern**

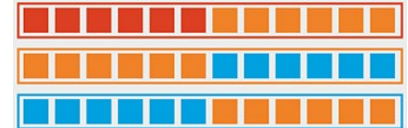

# Compartmentalized smart cooling

Enhanced design over the previous generation to separately detects the CPU and hard drive temperatures for dynamically adjusting separate fan speeds for an quieter operations in the office.

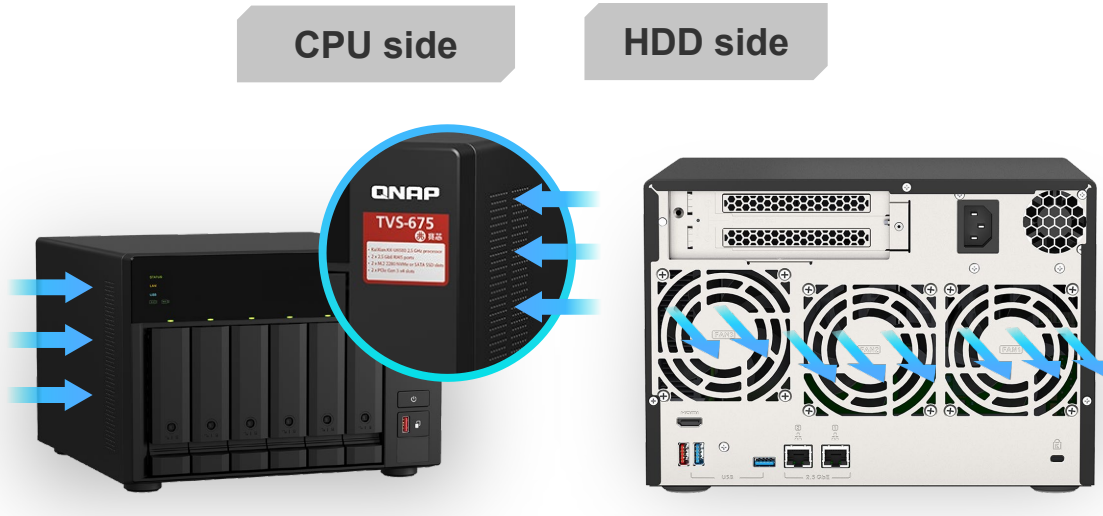

Noise Test : Sound pressure is measured at the front bystander position with low fan speed.

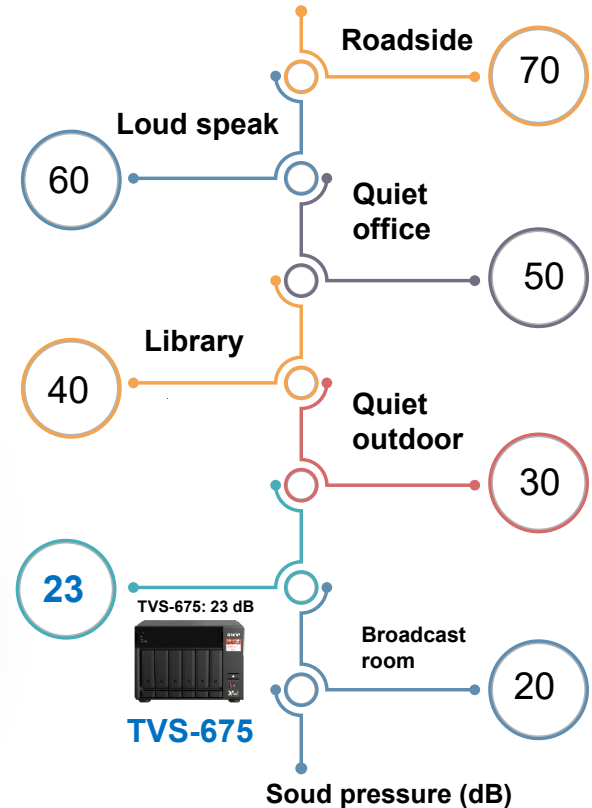

# Large 8GB DDR4 memory, ready for any app, and upgradeable to max 64GB RAM

**NAS Model Number:**

## **TVS-675-8G**

8 GB RAM (1 x 8 GB)

- 2 x DDR4 SO-DIMM RAM slots for a max of 64 GB (2 x 32 GB), dual-channel support
- QNAP 8/16/32 GB RAM modules for easy upgrade and better multi-app or multi-user usage.

**1. Remove the cover**

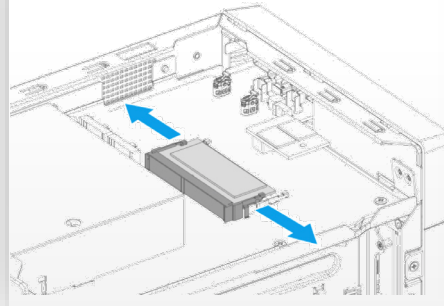

**2. Remove the old RAM (optional)**

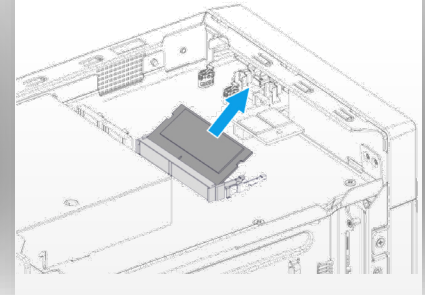

**3. Install the new RAM**

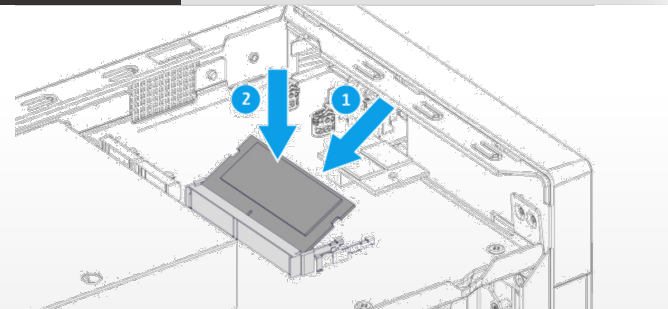

# 2 x 2.5 GbE LAN ports supporting link aggregation for maximum 5Gbps combined bandwidth



2.5GbE-supported motherboards, Wi-Fi 6 AP, switches, and LAN cards are now becoming popular

## 2.5GbE benefits



### 2.5X the speed



1GbE to 2.5GbE

Huge leap in performance

### Same cable

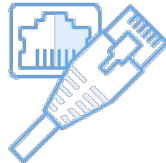

Use the same Cat.5e/  
Cat.6 / Cat. 6A  
LAN cables

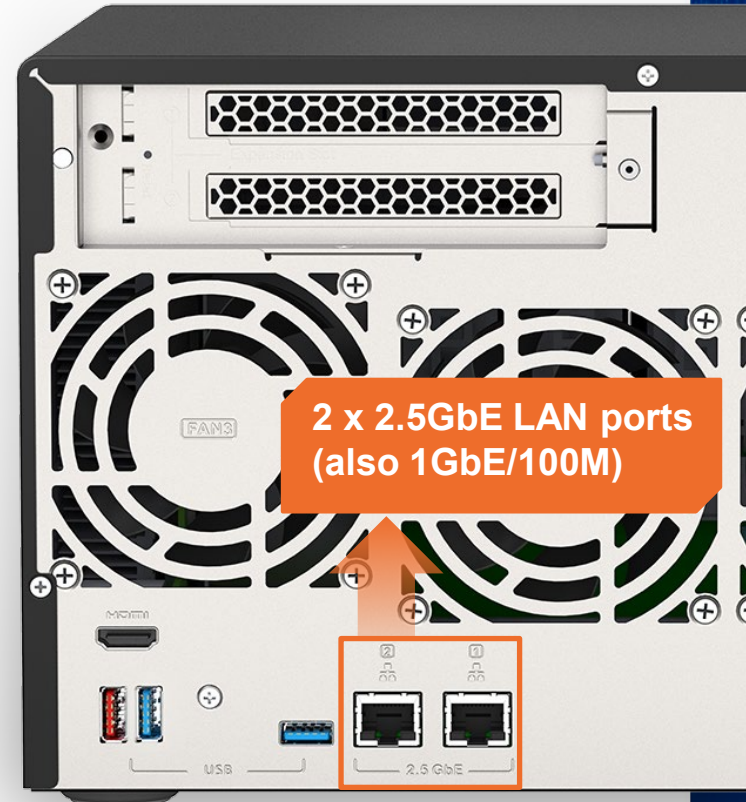



# Powerful integrated graphics processing unit to support 4K video transcoding and HDMI output

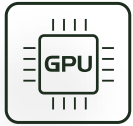

KX-6580 with C-960 graphic chipset, provide high performance transcoding and original 4k video output ability.

**Built in C-960 graphics**



**Support 4K video**



**4k video output**

**Hardware transcoding**



**Support h.264/265  
Hardware transcoding**



**HDMI 2.0 port**

# 2 x PCIe slots for network, storage, and more

2 x PCIe Gen3 x4 expansion slots for various QNAP  
PCIe cards for more value-added applications.

2 x PCIe Gen3 x4

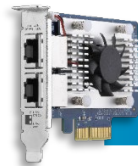
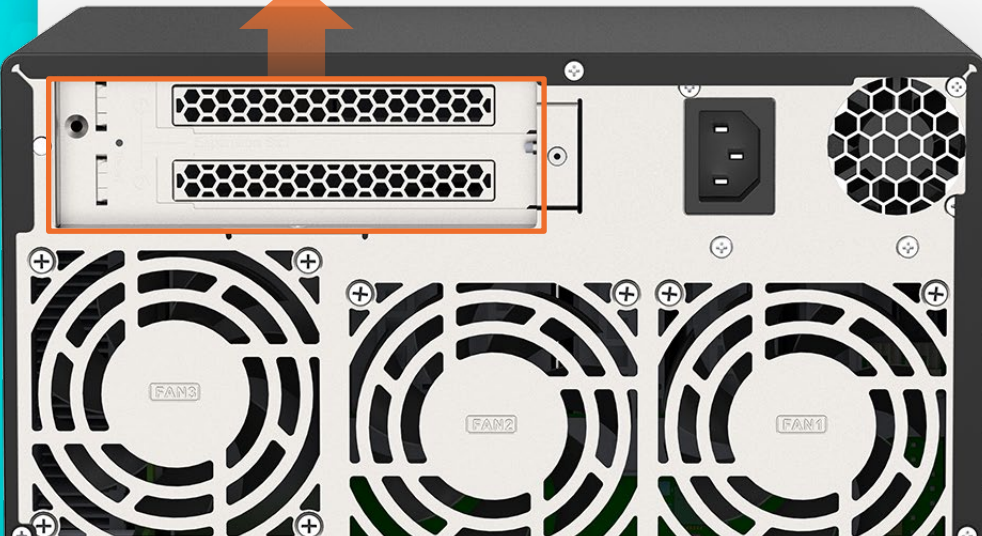

**QXG** 10GbE/5GbE/2.5GbE  
Network Interface Card

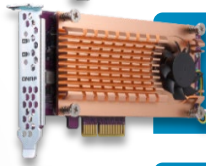

**QM2** M.2 SSD expansion  
card

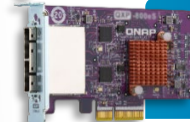

**QXP** SAS, SATA, USB  
expansion card



**QXP** Wi-Fi 6 and FC  
expansion card



**QWA-AC2600** Wi-Fi AP card  
Wi-Fi 5 2.4GHz/5GHz wireless AP

# QM2 cards add support for SSD caching and 10GbE connectivity

- QM2 M.2 SSD PCIe cards allow adding 2 or 4 M.2 NVMe / SATA SSDs to TS-x73A. Enable SSD caching or create RAID 5 group with the two on-board M.2 NVMe SSDs using Qtier.
- Maximize the storage capacity and performance without occupying any 3.5" drive bays. Some QM2 models even combine M.2 SSD and 10GBASE-T connectivity into one solution.

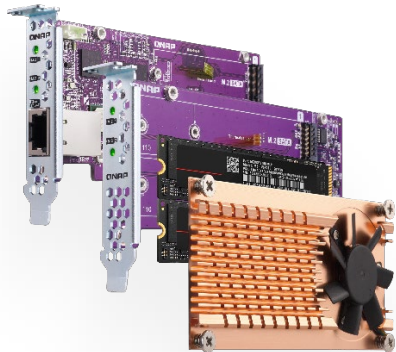

## Active cooling module

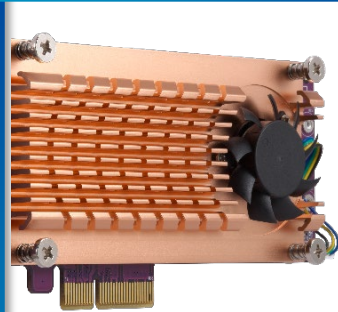

Thermal sensors allow real-time temperature monitoring and adjust fan rotation speed

## Compatible with standard PCIe slots

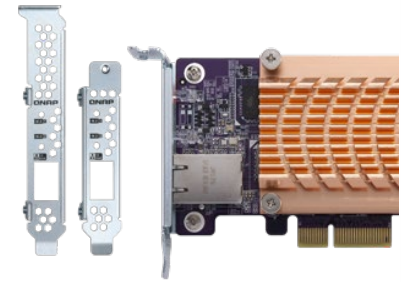

Low-profile PCIe card including full-height bracket

# QM2 Series - Add more M.2 SSD slots to TVS-675

2 x M.2 SSD  
+ 10GbE or 2.5GbE



**QM2-2S10G1TA**

Bandwidth: PCIe Gen2 x4  
2 x M.2 SATA 6Gbps  
+ 1 x 10GBASE-T

**QM2-2P10G1TA**

Bandwidth: PCIe Gen2 x4  
2 x M.2 PCIe Gen2 x2  
+ 1 x 10GBASE-T

**NEW**

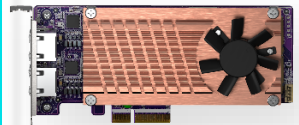

**QM2-2P2G2T**

Bandwidth: PCIe Gen3 x4  
2 x M.2 PCIe Gen3 x2  
+ 2 x 2.5GbE

2 x M.2 SSD

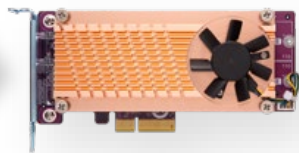

**QM2-2P-344**

Bandwidth: PCIe Gen3 x4  
2 x M.2 PCIe Gen3 x4

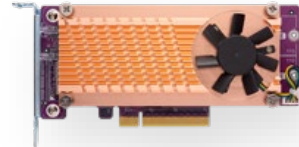

**QM2-2P-384**

Bandwidth: PCIe Gen3 x8  
2 x M.2 PCIe Gen3 x4

4 x M.2 SSD

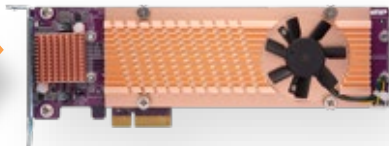

**QM2-4P-342**

Bandwidth: PCIe Gen3 x8  
2 x M.2 PCIe Gen3 x4

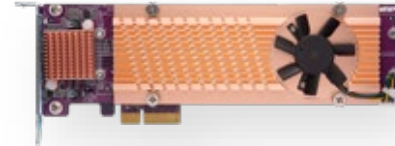

**QM2-4P-384**

Bandwidth: PCIe Gen3 x8  
4 x M.2 PCIe Gen3 x4

# Budget-friendly unmanaged switches for multi-user environment

Fanless & metal housing



## QSW-1105-5T (Unmanaged)

5 x 2.5GbE Multi-Gig RJ45



## QSW-2104-2S (Unmanaged)

2 x 10GbE SFP+ / 4 x 2.5GbE Multi-Gig RJ45



## QSW-2104-2T (Unmanaged)

2 x 10GbE RJ45 / 4 x 2.5GbE Multi-Gig RJ45



## QSW-1208-8C (Unmanaged)

8 x 10GbE Multi-Gig RJ45 / SFP+ combo  
4 x 10GbE SFP+



## QSW-308-1C (Unmanaged)

1 x 10GbE Multi-Gig RJ45 / SFP+ combo  
2 x 10GbE SFP+  
8 x 1GbE RJ45

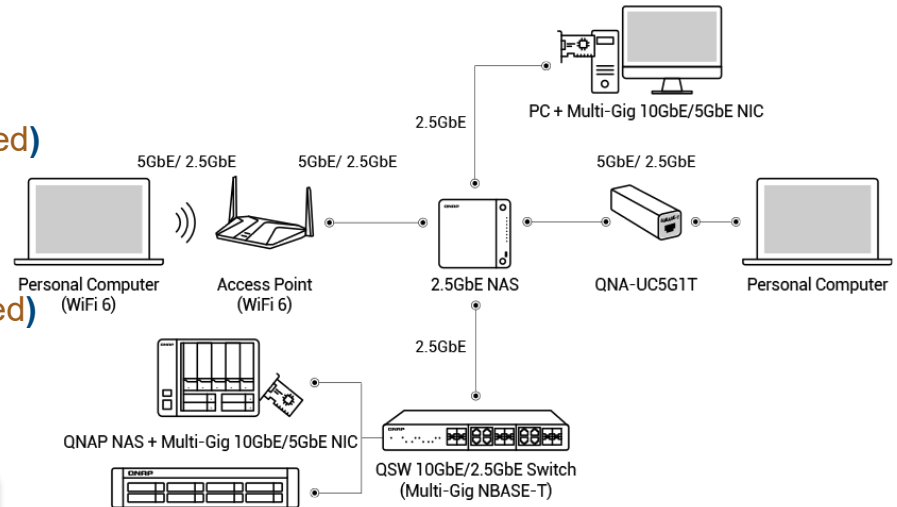

# Layer-2 managed switches for multi-user environment and efficient deployment



**QSW-M1208-8C (Managed)**

8 x 10GbE Multi-Gig RJ45 / SFP+ combo  
4 x 10GbE SFP+



**QSW-M1204-4C (Managed)**

4 x 10GbE Multi-Gig RJ45 / SFP+ combo  
8 x 10GbE SFP+

Keep existing wiring for **2.5GbE**

	CAT 5e	CAT 6	CAT 6A
100M	✓	✓	✓
1G	✓	✓	✓
2.5G	✓	✓	✓
5G	✓	✓	✓
10G	X	✓ (55m)	✓

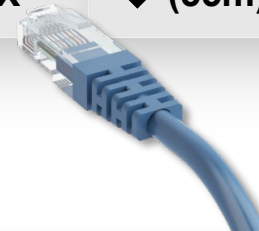

**QSW-M804-4C (Managed)**

4 x 10GbE Multi-Gig RJ45 / SFP+ combo  
4 x 10GbE SFP+



**QSW-M408-4C (Managed)**

4 x 10GbE Multi-Gig RJ45 / SFP+ combo  
8 x 1GbE RJ45



**QSW-M408-2C (Managed)**

2 x 10GbE Multi-Gig RJ45 / SFP+ combo  
2 x 10GbE SFP+  
8 x 1GbE RJ45

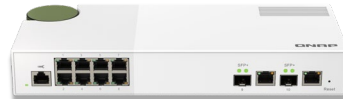

**QSW-M2108-2C (Managed)**

2x 10GbE Multi-Gig RJ45 / SFP+ combo  
8 x 2.5GbE RJ45

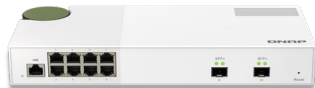

**QSW-M2108-2S (Managed)**

2 x 10GbE SFP+  
8 x 2.5GbE RJ45



**QSW-M2108R-2C (Managed)**

2x 10GbE Multi-Gig RJ45 / SFP+ combo  
8 x 2.5GbE RJ45

# Optional 10GbE NIC for fast performance

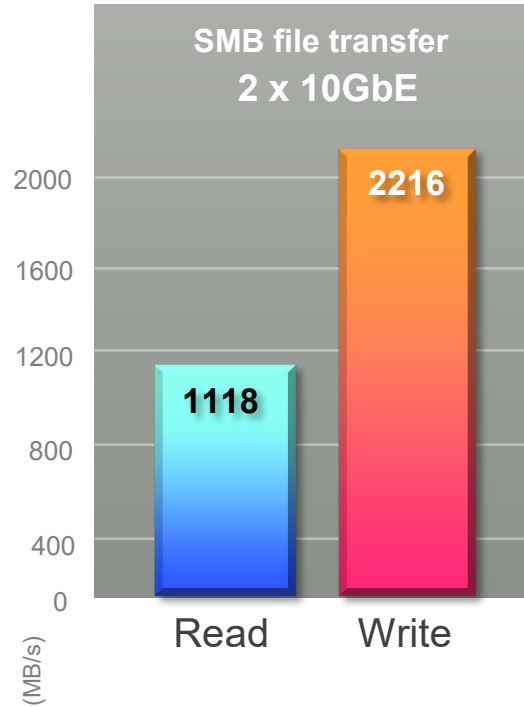
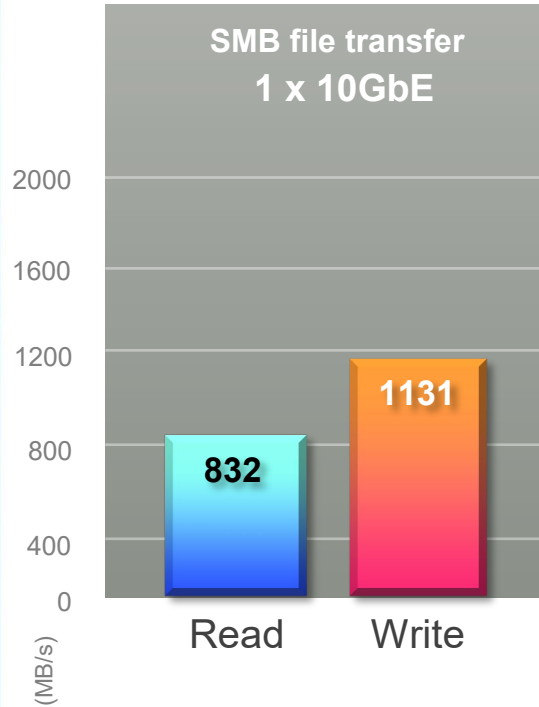

2 x PCIe Gen3 x4 slots for 10GBASE-T & 10GbE SFP+ cards

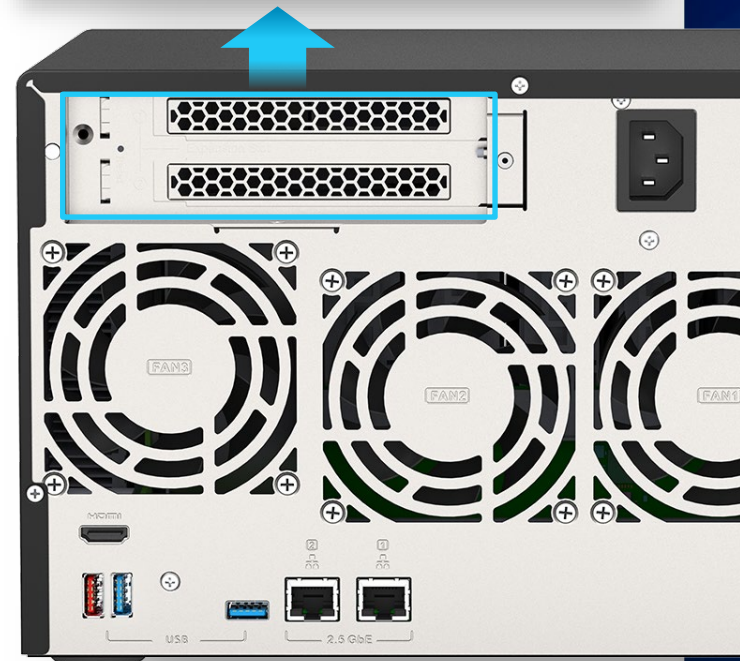

Test Environment:  
NAS | TVS-675-8G, QTS 4.5.1, 8 x Samsung 850 Pro 512GB SSD, RAID 5, LAN-10G2SR-MLX  
Client PC | Windows 10 Pro, Intel Core i7-6700 3.4 GHz, 64GB RAM, LAN-10G2SR-MLX.

# Network accessories - NIC

## 10GbE NIC

2 x RJ45

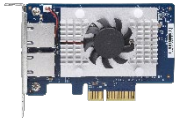

QXG-10G2T-107

1 x RJ45



QXG-10G1T

2 x RJ45



LAN-10G2T-X710

2 x SFP+

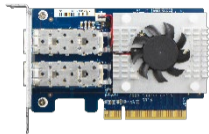

QXG-10G2SF-CX4

2 x RJ45

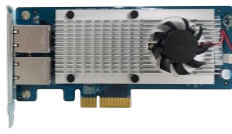

LAN-10G2T-X550

## 5GbE NIC

1/2/4 x RJ45

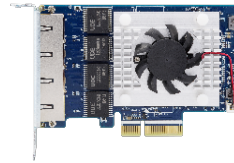

QXG-5G1T-111C

QXG-5G2T-111C

QXG-5G4T-111C

## 2.5GbE NIC

1/2/4 x RJ45

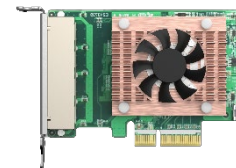

QXG-2G1T-I225

QXG-2G2T-I225

QXG-2G4T-I225



# QNAP 16Gb/s Fibre Channel card for FC SAN

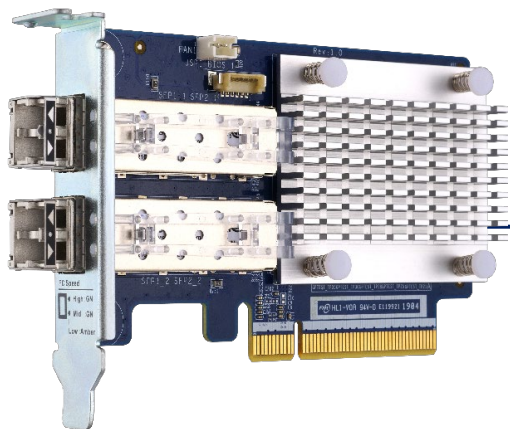

**QXP-16G2FC**  
Dual-port 16Gbps  
FC card with 16Gb FC  
transceivers

Manage Fibre Channel connection  
using **iSCSI & Fibre Channel** app

**16Gb FC transceiver (spare parts)**

**TRX-16GFCSFP-SR**  
16Gb/8Gb/4Gb



# QNAP QXP-W6-AX200 Wi-Fi 6 card connects NAS wirelessly to a Wi-Fi 6 AX network



QNAP TVS-675 NAS

+



Install the QXP-W6-AX200  
PCIe Wi-Fi 6 card



QNAP QHora-301W  
Wi-Fi 6 10GbE SD-WAN router

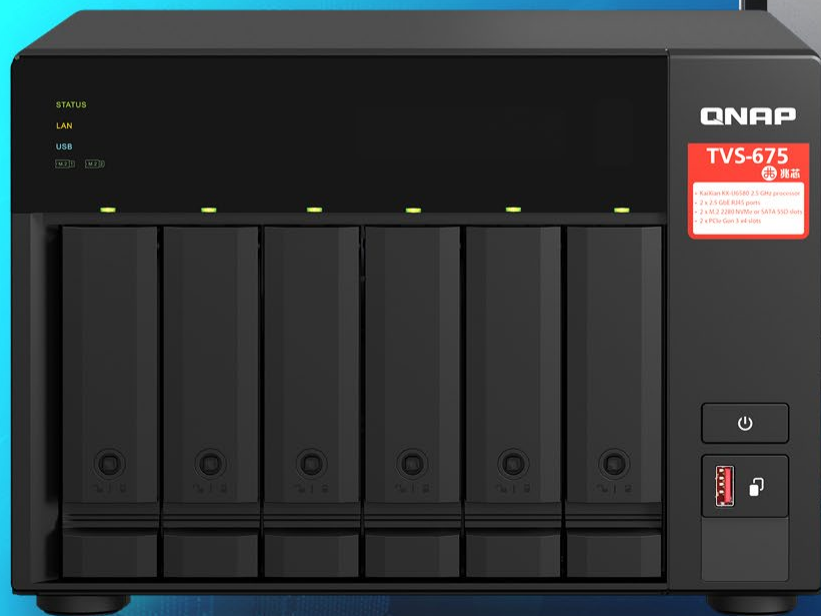

# Connect to Dropbox, OneDrive, Google Drive and more



Qfile

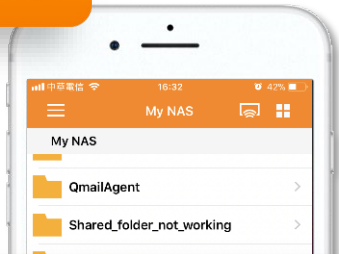

- USBDisks1
- Web
- GoogleDrive (linuslin@qnap.com)
- Linus431P
- home (admin@Linus431P)
- Dropbox (linuslin@qnap.com)

Local  
NAS

Remote  
NAS

Cloud Storage



File Station

FileStation 5

名稱	修改日期
test	1970/01/01 01
qmail test	1970/01/01 01
test2	1970/01/01 01
test2-複製(1)	1970/01/01 01
test2-複製(2)	1970/01/01 01
@QCloudSync	1970/01/01 01
enctest	1970/01/01 01
Hello_3.txt	2018/07/26 05
Hello_0 copy.txt	2018/07/26 05
Hello_0.txt	2018/07/26 05
Hello_2.txt	2018/07/26 04
ABDCEFG-複製(1).docx	2018/07/26 04
IMG_0033.MOV	2018/07/26 04
ABDCEFG.docx	2018/07/25 03

# Easily make NAS your team collaboration portal with File Station



	Edit with Office Online	View in Google Docs	Open with Google Chrome Extension
<b>Requirement</b>	CloudLink needs to be enabled	CloudLink needs to be enabled	Use Chrome with extension "Office Editing for Docs, Sheets & Slides" to open
<b>Supported formats</b>	.docx, .pptx, .xlsx	.doc, .ppt, .xls .docx, .pptx, .xlsx	.doc, .ppt, .xls .docx, .pptx, .xlsx
<b>Capabilities</b>	<ul style="list-style-type: none"> <li>•File collaboration</li> <li>•Auto save to NAS in real time</li> </ul>	<ul style="list-style-type: none"> <li>•Document preview</li> <li>•Convert to Google docs for editing &amp; saving in your Google Drive</li> </ul>	<ul style="list-style-type: none"> <li>•Document preview</li> <li>•Convert to Google docs for editing &amp; saving in your Google Drive</li> </ul>

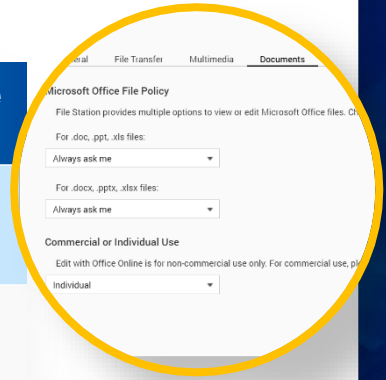

Select the default open action based on your preference in Settings > Documents.



Save to NAS in real time

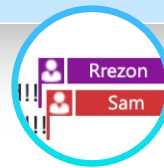

Multi-user online editing

# Qsync 5.0 – Cross-device file sync for individuals and teams

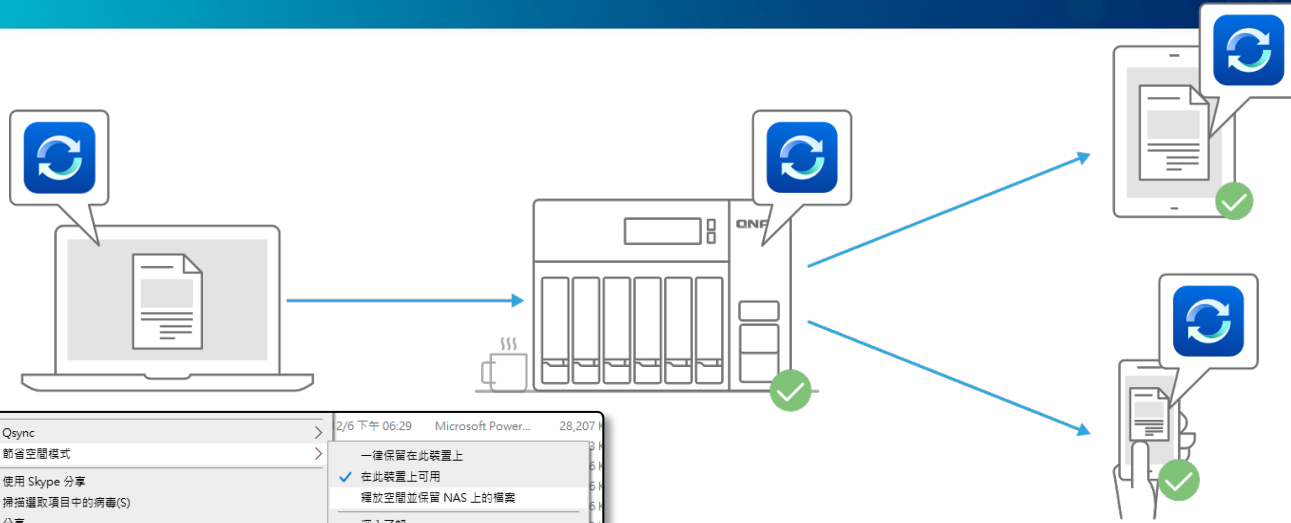

Windows & macOS  
Space-Saving Mode!

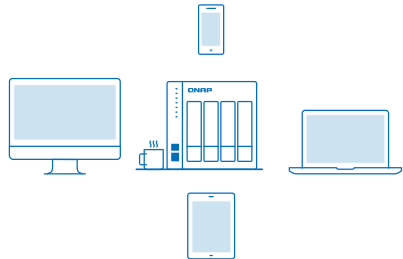
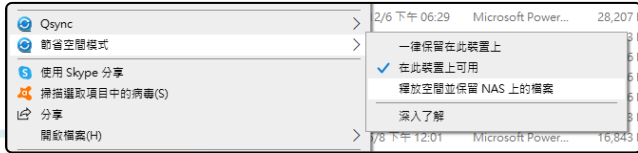

If you own many devices, any file changed on one device will be automatically synchronized with the others.

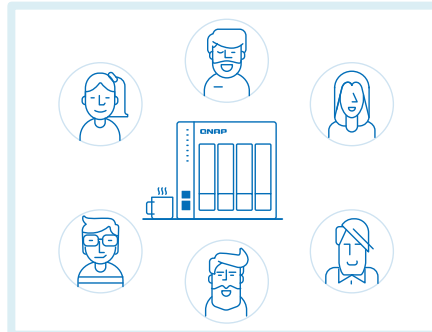

For team works, any file changed will be automatically distributed to your teams' devices, accelerating and streamlining your workflows.

# Complete backup with 3-2-1 HBS 3

## HBS 3 (Hybrid Backup Sync 3)



From local NAS  
(via HBS 3)

From remote NAS  
( via File Station )

Carry and use  
(QuDedup Extract Tool)



Backup/Restore

Taipei

TCP BBR



File Station with QuDedup



Access from Cloud

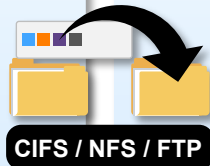

CIFS / NFS / FTP



Windows

Tokyo



MacOS

New York

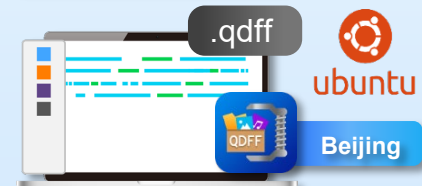

ubuntu

Beijing



File Station with QuDedup

Taipei





# Hyper Data Protector : All-in-one active backup solution for virtual machines

- Supports VMware and Microsoft Hyper-V
- Unlimited VM backups and license-free
- Active backup solution
- Restore at any time point
- Constant monitoring

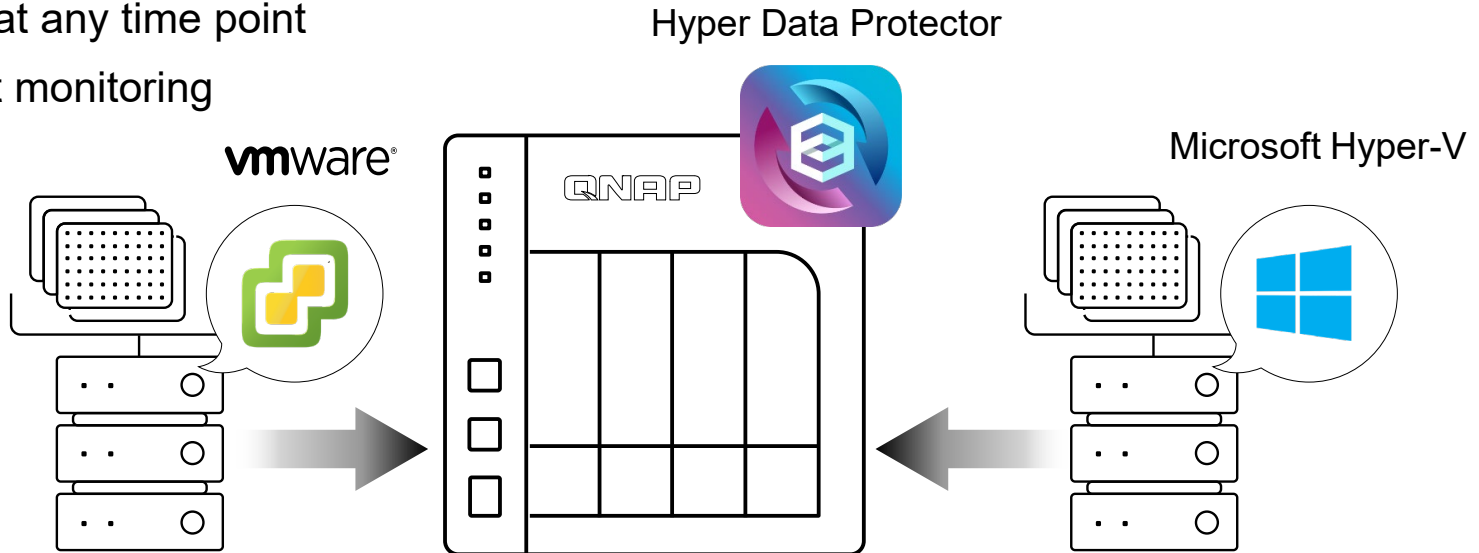

# Boxafe: Comprehensive Backup Solution for Google Workspace and Microsoft 365



- **Keep important data in your hands**
- **Move older data out of the cloud to reduce cost**

## Google™ Workspace



### Gmail

Backup all your emails and attachments in Gmail



### Google Drive

Backup all your file versions in Google Drive and supports My Drive and Shared Drive



### Contacts

Backup all your contacts in Google Contacts



### Calendar

Backup all your events and attachments in Google Calendar

## Microsoft 365®



### Outlook

Backup all your emails and attachments in Outlook



### Contacts (People)

Backup all your contacts in Outlook People



### Calendar

Backup all your events and attachments in Outlook Calendar



### OneDrive

Backup all your files in OneDrive and support SharePoint

# HybridMount - Cascade share the access permission to remote devices

The remote data mounted by SMB/NFS can be shared with other devices with folder permission to achieve a cascade share architecture.

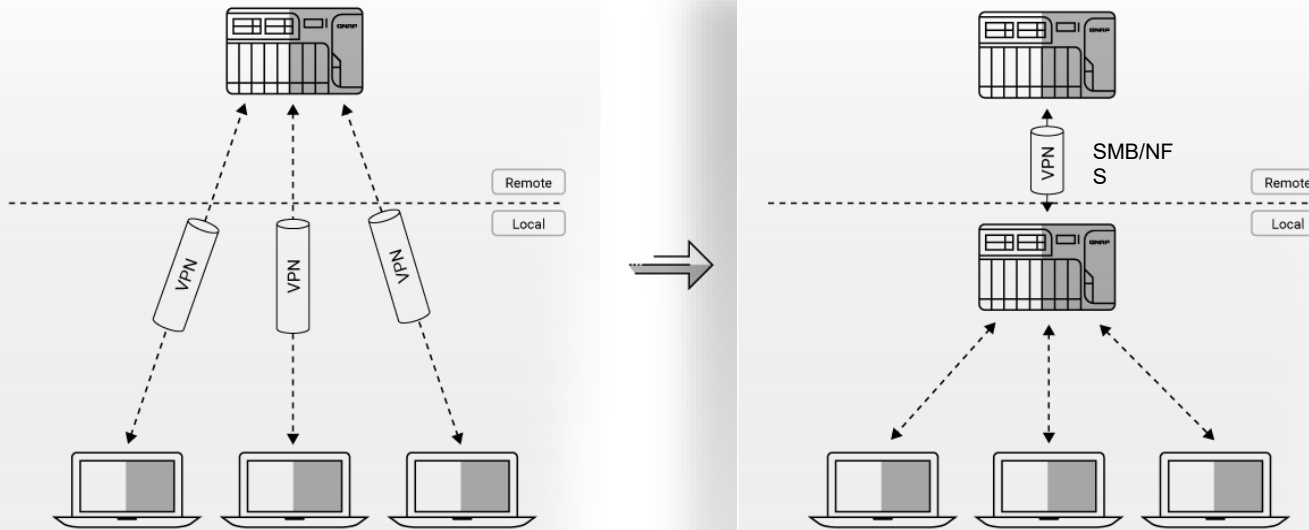

- To avoid local users accessing the remote data by VPN and to reduce the security concern and risk of VPN.
- No longer need to manage user accounts in the remote server. The local admin retains full control over assigning different permissions to local users.

# QmailAgent – email backup solution

## Best Email Retention Solution

- Collectively manage and back up your personal and business emails.
- Easily auto back up all your emails and attachments.
- Quickly search and gain access to specific messages.
- Back up emails for disaster recovery.
- Encryption service protects backed up private emails.

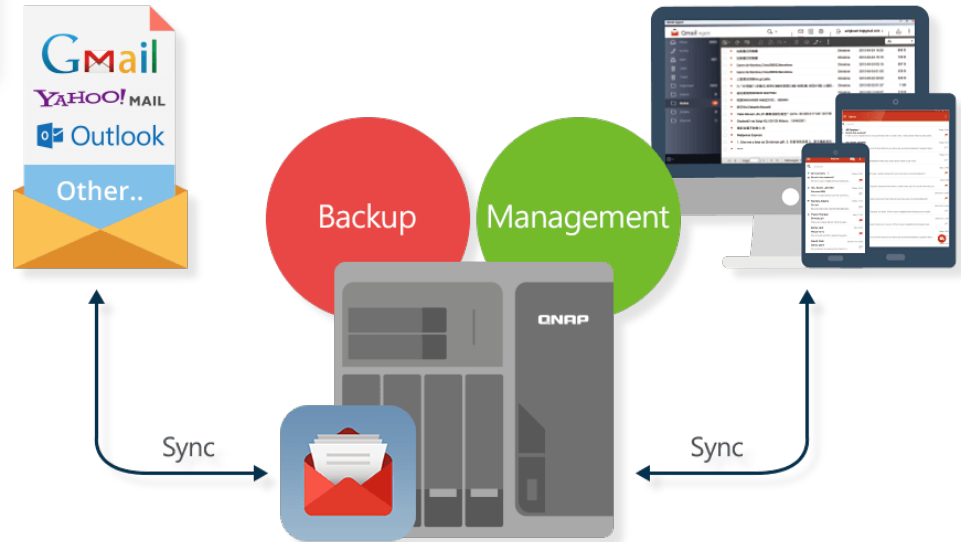

# All-in-one 8-core server with max 64GB RAM to host virtual machines and containers



## Virtualization Station

Supports to run the Virtual machine such as Windows, Linux®, UNIX® and Android.



## Container Station

QNAP's Container Station exclusively integrates LXC and Docker lightweight virtualization technologies, allowing you to download apps from the built-in Docker Hub Registry.

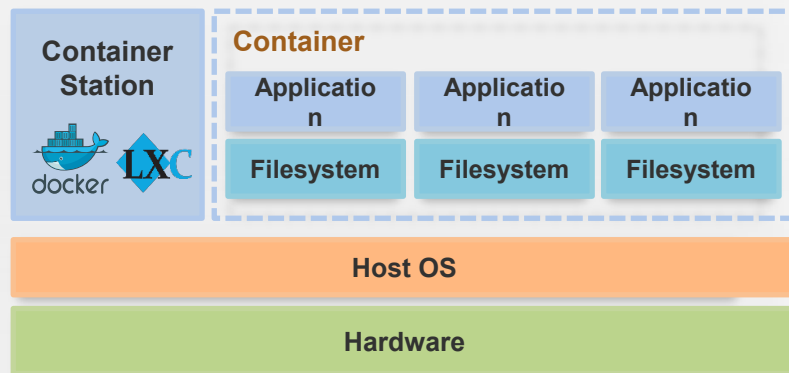

# Establish and run dual systems - Ubuntu & QuTS hero



## Ubuntu Linux Station

- Run QuTS hero and Ubuntu dual system, dual system application to enjoy.
- One-click installation of multiple versions Ubuntu: 16.04 / 18.04 / 20.04
- Ubuntu Software Center enjoy a variety of application downloads
- Remotely access the Ubuntu Linux desktop through a browser /
- Install a PCIe graphic card to add an HDMI output screen, and use a USB keyboard and mouse with it.



INTERNET



# Smart and automatic file management



## Qsirch 5

### A powerful, Google™-like search tool

- Search image, music, video, document, and email by keyword and filters.
- 5 advanced image search: search by face, text in image, things, color and map.
- Supports Qfiling to perform archival tasks based on your search criteria.



## Qfiling 3

### Automatically filing and archiving

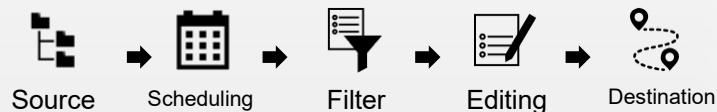

- 2 type of task: filing task, recycling task
- 3 type of scheduling rule: one-time, scheduling, real-time
- 9 editing module: AI face blur, encryption and decryption, video transcoding and so on

# Notification Center - diversity of active notification



## Centralized setting

One interface to integrate all notification settings and operations



## Multiple notification methods

Meet your various notification scenarios



## Highly flexible rule setting

Easily filter important messages



## Multi-language support

Support 23 language & composed by professionals



## Double insurance

Notification history and test function

Name	Model	OS Version	App Version	Action
admin (1)				
admin_Windows_Firefox	Windows	firefox 61	QTS Browser Notification 4.3.5	

**Edit Rule for Event Notifications**

Name and Events | **Notification Criteria** | Methods and Recipients

Severity Level

Information  Warning  Error

Notification Language

Keyword Filter

Only send notifications for events that occur during a certain time period.

Time range: 00 : 00 ~ 23 : 59

Confirm Cancel



# QuLog Center proactively analyze and monitor connections

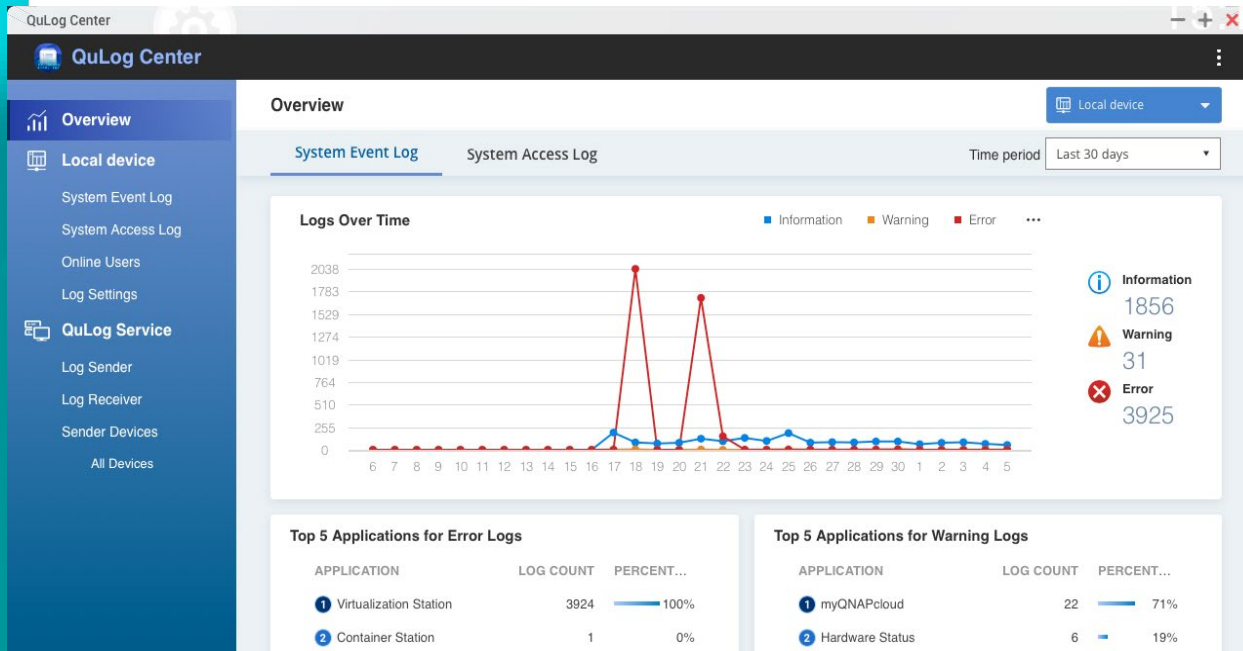

## ● Proactive analysis

- List the top 5 Applications for Error/Warning Logs
- System access statistics such as connection types and logged in IP

## ● Quick filtering

- Categorize by APP name or date
- Customize labels/styles/flags for advanced search

## ● Real-time monitoring

- View the online members and their connection types

## ● Unified management

- Consolidate detailed local and remote NAS record files
- Set the size of the space for the record
- Send NAS log files to a standard Syslog server
- Notify specified notifications by Notification Center

# Brand new surveillance app QVR Elite



## Channel License Type Unlimited

QVR Elite is subscription-based, with monthly, yearly, and 3-year subscription plans. You can build a robust surveillance system with a low-cost monthly price of US \$1.99 per channel. You can alter the subscription based on your needs to reach higher cost efficiency.

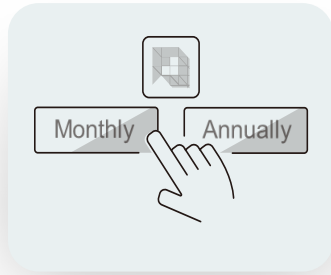

## Performance Evaluation

At initial version, max recording channel is 128 channels, the next version we will increase it to 192 channels.

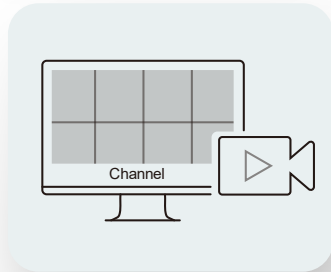

## QVR Pro Client

- Supported by the QVR Pro Client same as QVR Pro's client
- Same features include Dynamic View Layout, Live and Playback at the same time, and e-map event display

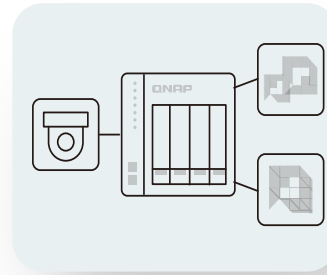

## Standard MP4 file

- Supported by both QuTS hero and QTS
- Record standard MP4 format, allowing for smooth playback on all devices

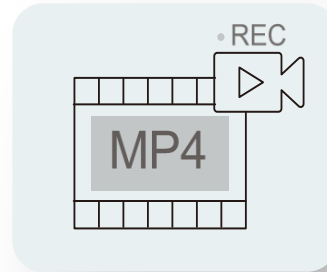

# High-performance multimedia streaming platform



**QuMagie AI smart photo albums  
and auto classification**



**CAYIN MediaSign Player  
HEVC (H.265) video transcoding**



**Use Cinema28 for  
multi-room streaming**



**Plex Server media streaming**

*\*Transcoding will support in Aug/2021*





Enterprise-level OS

---

ZFS-based QuTS hero



# Silent data corruption & self-healing

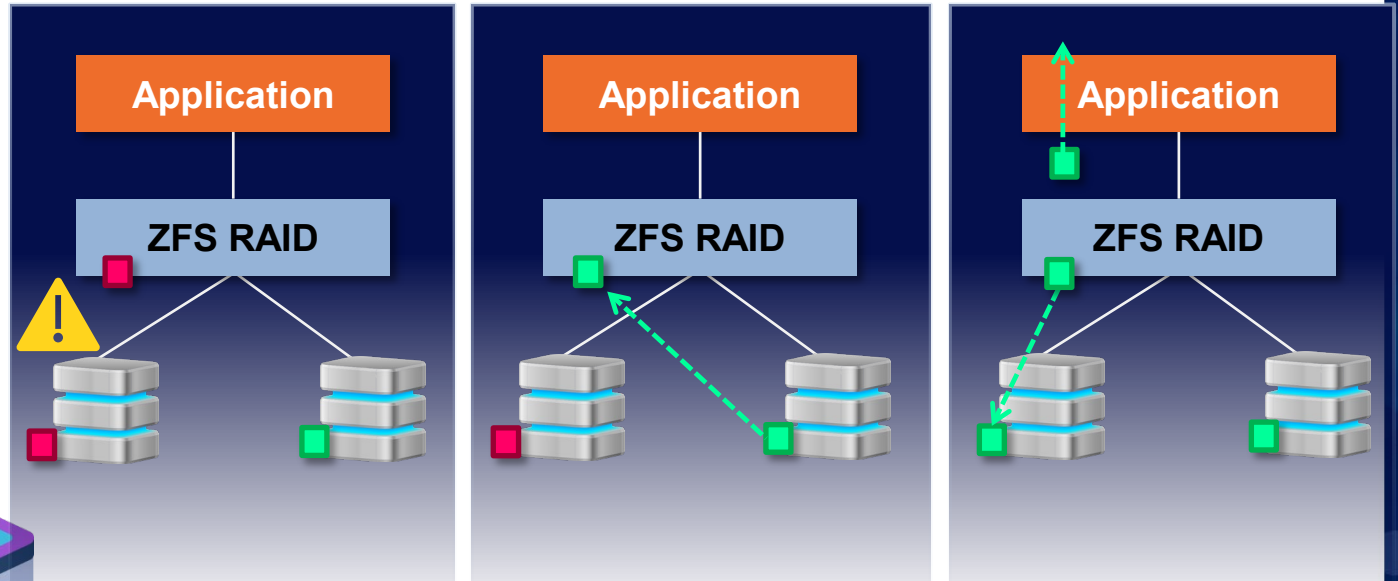

**Avoid data silent corruption that occurred on running system**

# Three-layer backup solution

## Builds the most complete data backup protection

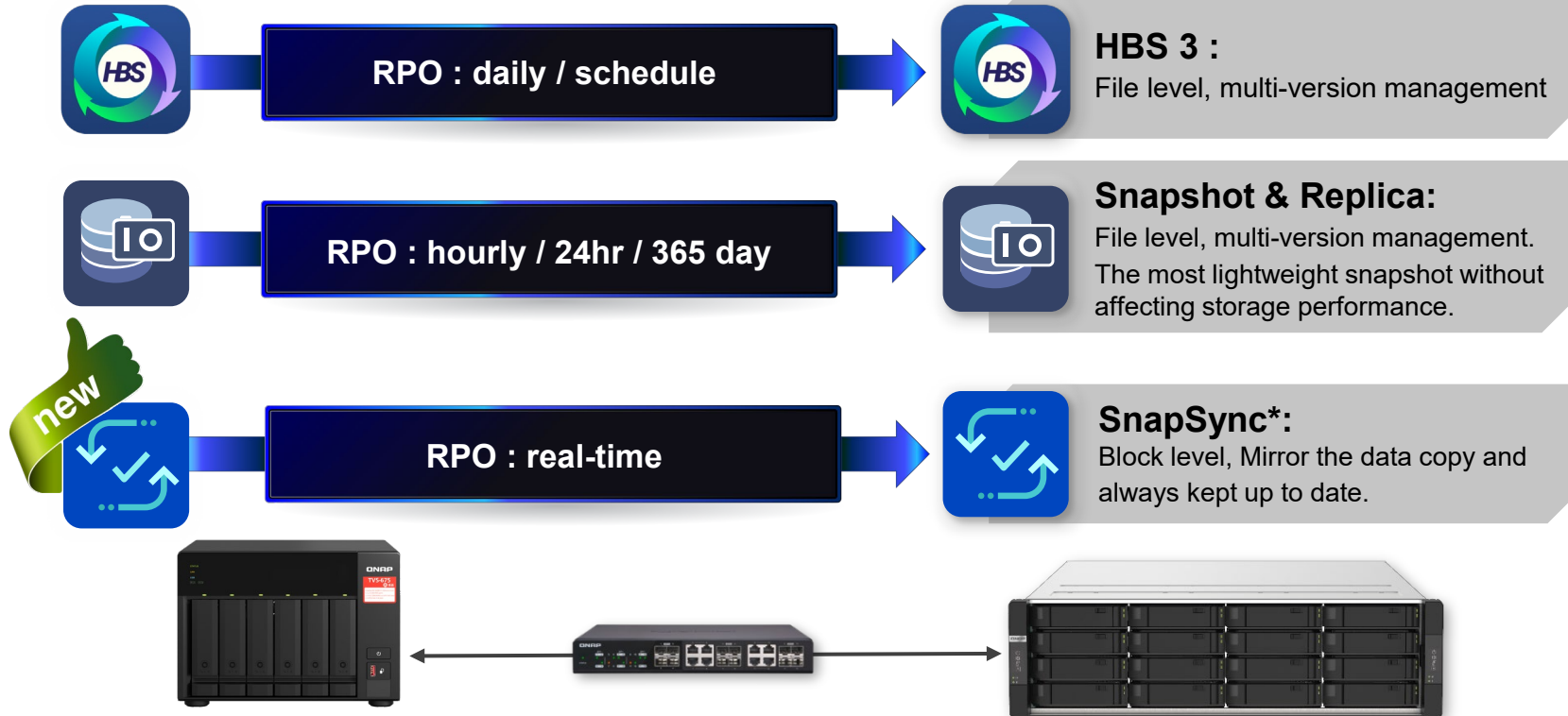

\*SnapSync will be available on QuTS hero h4.5.2

# SnapSync

The most cost-effective backup, data protection and disaster recovery solution

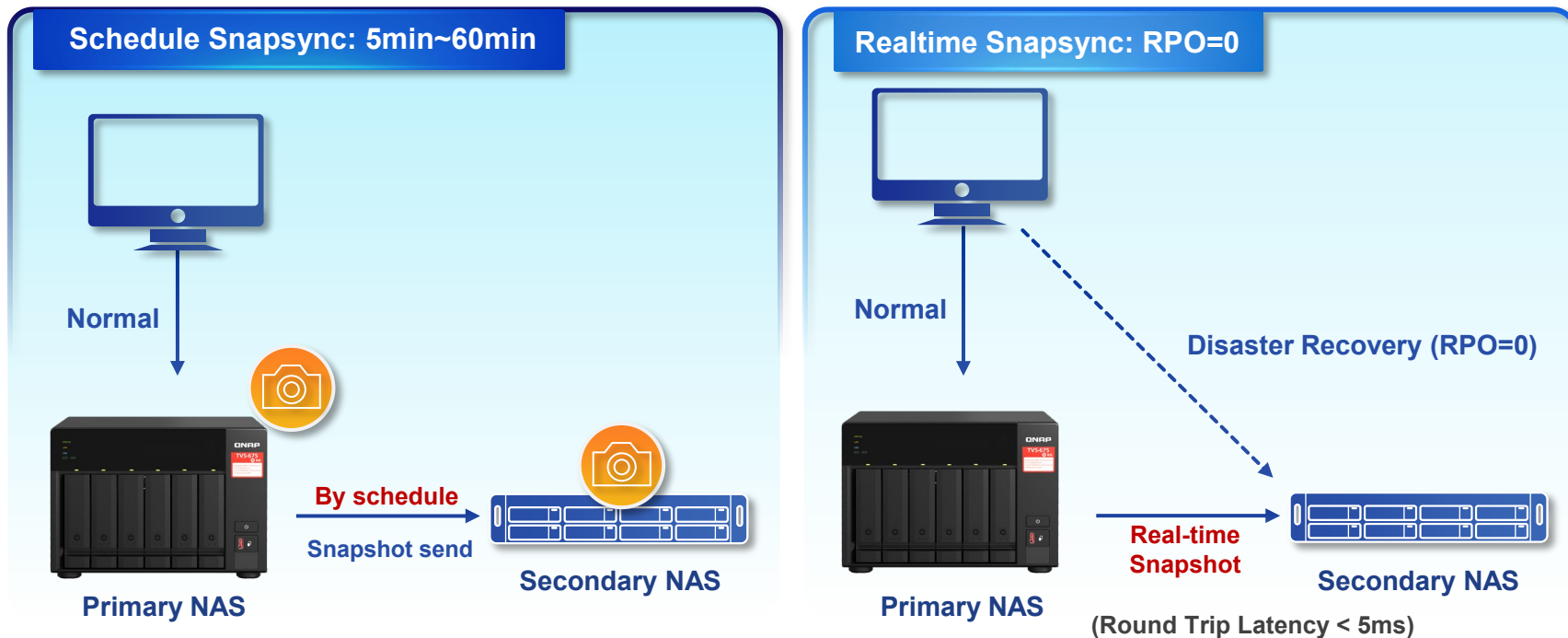



# Multiple Storage

---

# Expansion Solutions



# Storage expansion: TR-002 / TR-004 USB RAID units

- NAS with a USB port can support TR USB RAID enclosures
- Integrated USB Type-C port for plug & play, supporting USB Type-A & Type-C hosts
- NAS can connect max. 2 of TR-002/TR-004 enclosures



**TR-002**

USB 3.2 Gen2 10Gbps



**TR-004**

USB 3.2 Gen1 5Gbps



**included**

USB 3.2 Gen 1 or Gen 2 Type-C to Type-A cable



**included**

Type-C to Type-C cable

# Storage expansion : TL-D800C USB JBOD unit

- NAS with a USB port can support TL USB JBOD enclosures
- USB Type-C provide speed up to USB 3.2 Gen 2 10Gb/s



TL-D800C



**included**

USB 3.2 Gen1 or Gen 2  
Type-C to Type-A cable



**included**

Type-C to Type-C cable

# High-speed storage expansion with PCIe to multi-channel SATA enclosures

- Install a QNAP QXP SATA HBA on NAS to access the TL expansion units via PCIe Gen3 bandwidth
- Each SFF-8088 cable provides 4 x SATA 6Gb/s = 24 Gb/s bandwidth. Connect multiple cables for up to 64 Gb/s performance



# QXP SATA HBA and cables are included in the TL-D400S/D800S/D1600S JBOD



**TL-D400S**



**1 x QXP-400eS-A1164  
PCIe to 4 x SATA 6Gb/s**



**1 x 1M SFF-8088  
cables**



**TL-D800S**



**1 x QXP-800eS-A116  
PCIe to 8 x SATA 6Gb/s**



**2 x 1M SFF-8088  
cables**



**TL-D1600S**



**1 x QXP-1600eS  
PCIe to 16 x SATA 6Gb/s**



**4 x 1M SFF-8088 to SFF-8644 cables**

# 3-year standard warranty and extend it up to 5 years via an optional purchase



## 3 years of standard warranty

- 3-year standard warranty service that comes in effect at the time of purchase.
- Free repair and part replacement for products under normal use during warranty period. (Spare parts and consumables are excluded)

## Optional 2 years of extended warranty

- Extending your warranty with this paid service, available within 270 days of the initial unit purchase.
- Offers identical service to standard warranty.

Part number: **EXTW-ORANGE-2Y**

# TVS-675 provides the best cost-performance ratio combining 8-core computing power and 4K graphics



TVS-675



TS-673A



TVS-673e

**EOL**

Processor	Zhaoxin KX-U6580	AMD V1500B	AMD RX-421BD
Cores	8	4	4
Threads	8	8	4
Base frequency	2.5 GHz	2.2 GHz	2.1 GHz
Turbo frequency	—	—	3.4 GHz
L2 cache	8MB	2MB	2MB
Max RAM	64GB	64GB	64GB
M.2 2280 SSD slots	2 x M.2 NVMe / SATA	2 x M.2 NVMe	2 x M.2 SATA
Integrated graphics	4K HDMI 2.0	—	4K HDMI v1.4b
Warranty	3 years	3 years	2 years



# TVS-675

Brand new 8-core SMB dual OS NAS

ZhaoXin KaiXian KX-U6580 8C / 8T 2.5GHz

Dual 2.5GbE \ M.2 NVMe/SATA SSD slots, PCIe 3.0 x4 slots

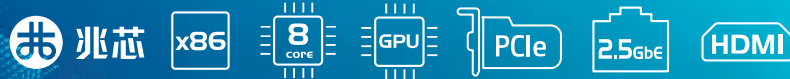

QTS / QuTS hero